

Pick the right tool for the job

We offer a variety of tooth shapes and sizes, ensuring we have what you need for your specific application. Finding the right balance of strength, penetration and wear life is vital to choosing the tip shape for your application.



Our ripper parts are high-quality after market castings made by Black Cat Blades.

CENTRELINE

Standard ripper tooth offering good penetration and wear life.



PENETRATION

A heavy duty rib reinforces the center of the tooth and improves direction of material.



We also make custom ripper shanks from Hardox that are harder, tougher and last longer.

Our sales and design team are experts at designing wear parts specifically optimised for your application. Give us a call so we can make you a custom Hardox ripper shank that will outlast the competition hands-down.



Custom-made 75mm Hardox CAT D7 Ripper Shanks

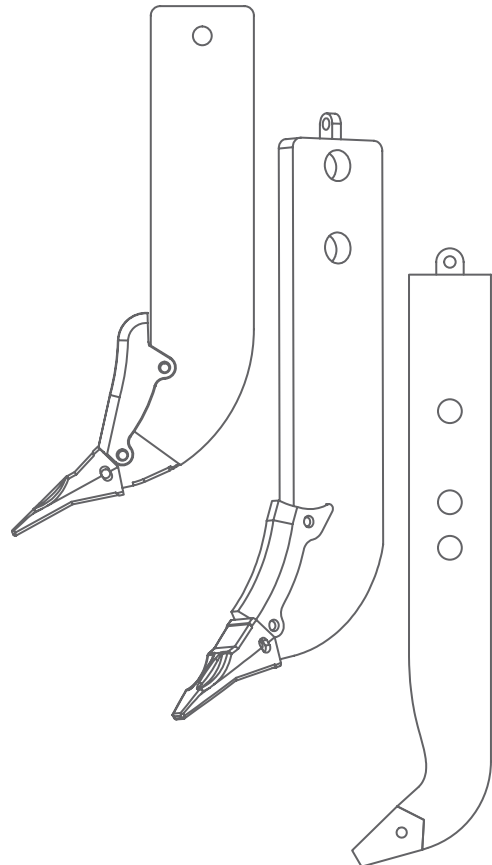

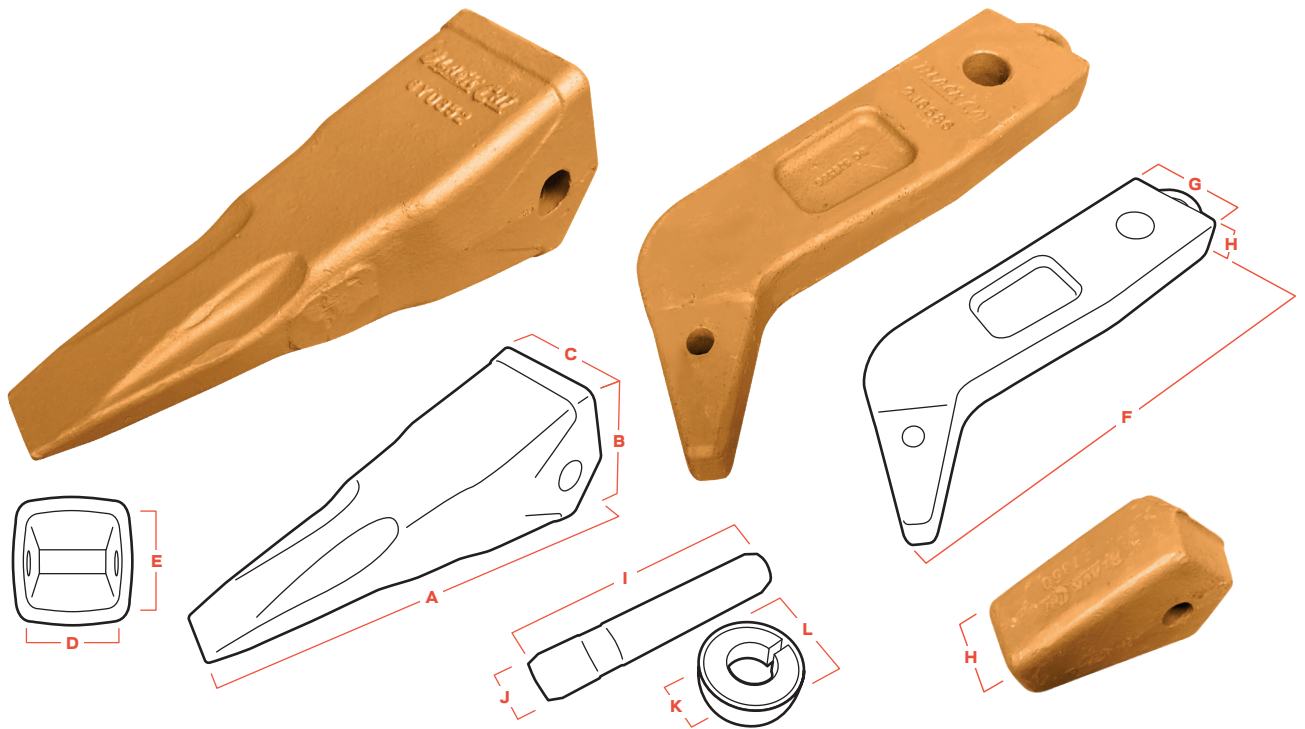

Boots

PRODUCT	PART NUMBER	WEIGHT (KG)	EXTERIOR			POCKET	
			A	B	C	D	E
D4/5 Penetration	RC-6Y0309	5.6	292	106	84	60	85
D6/7 Centreline	RC-6Y0352	12.7	356	148	120	77	115
D6/7 Penetration	RC-6Y0359	12.8	356	147	120	77	115

Shanks & Noses

PRODUCT	PART NUMBER	WEIGHT (KG)	F	G	H
			LENGTH	WIDTH	THICKNESS
D4/5 Ripper Shank	RC-9J8910	26.5	542	137	57
D4/5 Weld On Nose	RC-8E7300	2.5	-	-	52
D6/7 Weld On Nose	RC-8E7350	5.5	-	-	65

Pins & Retainers ∅ = Diameter

PRODUCT	PART NUMBER	WEIGHT (KG)	PIN		RETAINER	
			I	J	K	L
			LENGTH	DIAMETER	INTERNAL ∅	EXTERNAL ∅
D4/5 Ripper Pin	RC-9W2668	0.2	89	19	-	-
D4/5 Retainer (also J350)	TC-8E6359	0.2	-	-	18.5	40
D6/7 Ripper Pin (also J350)	TC-8E6358	0.3	105	19	-	-
D6/7 Retainer (also J350)	TC-8E6359	0.1	-	-	18.5	40

All measurements in millimetres.



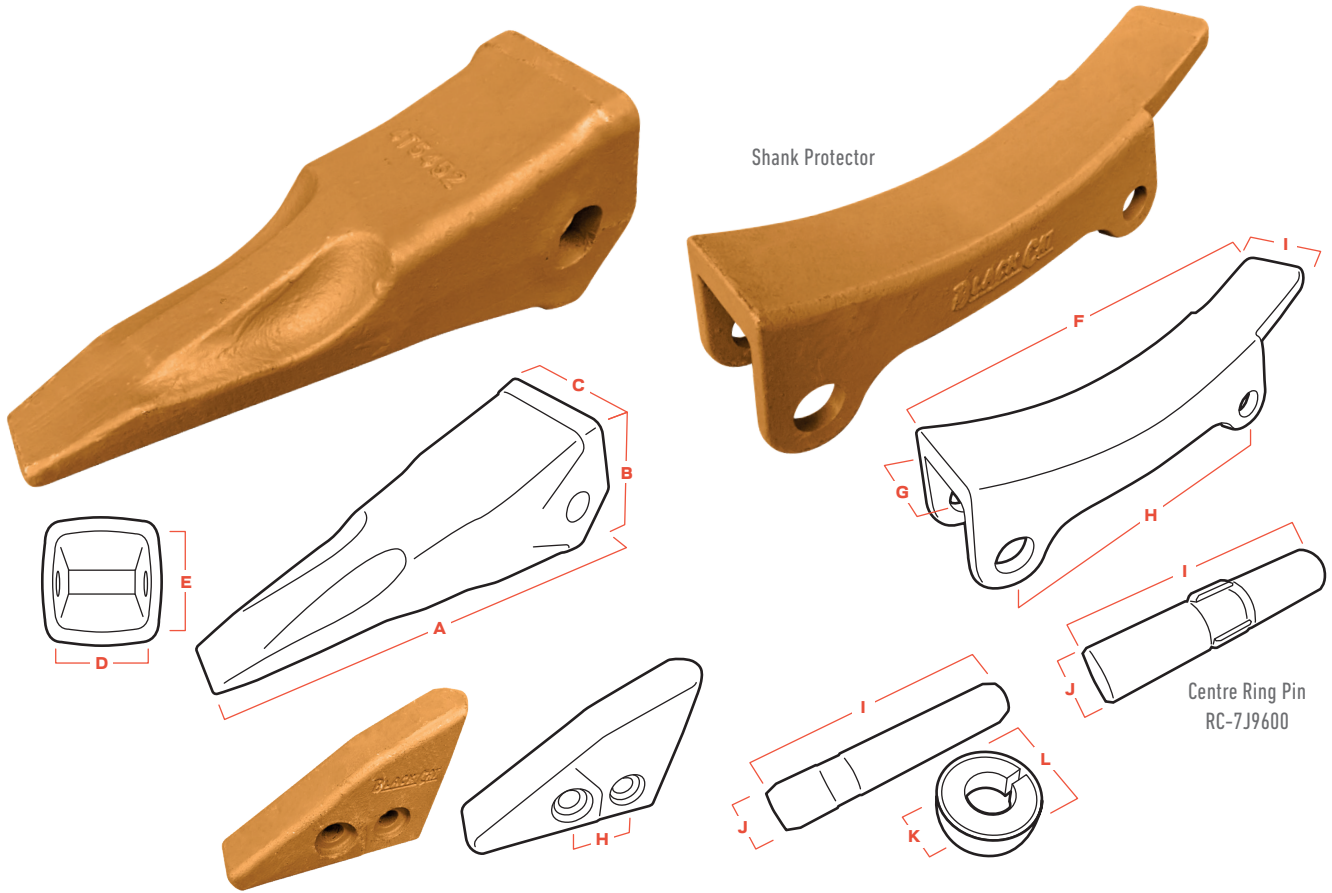

Boots

PRODUCT	PART NUMBER	WEIGHT (KG)	EXTERIOR			POCKET	
			A	B	C	D	E
D8/9 Centreline Intermediate	RC-9W2452	22.4	381	171	143	88	130
D8/9 Penetration Intermediate	RC-4T5452	18.7	397	173	143	88	130

Noses & Protectors

PRODUCT	PART NUMBER	WEIGHT (KG)	F	G	H	I
			LENGTH	INTERNAL GAP	HOLE SPACING	THICKNESS
D8/9 Weld On Nose	RC-9U9694	20.0	-	-	83	75
D8/9 Shank Protector	RC-6J8814	13.7	432	80	311	108
D8/9 HD Shank Protector	RC-8E1848	25.5	486	82	311	127

Pins & Retainers

∅ = Diameter

PRODUCT	PART NUMBER	WEIGHT (KG)	PIN		RETAINER	
			I	J	K	L
D8/9 Ripper Pin – Centre Ring	RC-7J9600-4T2479	0.5	119	25.4		
D8/9 Ripper Pin	RC-6Y3394	0.5	128	25	-	-
D8/9 Retainer (same as J550)	TC-8E5559	0.1	-	-	24.5	53

All measurements in millimetres.

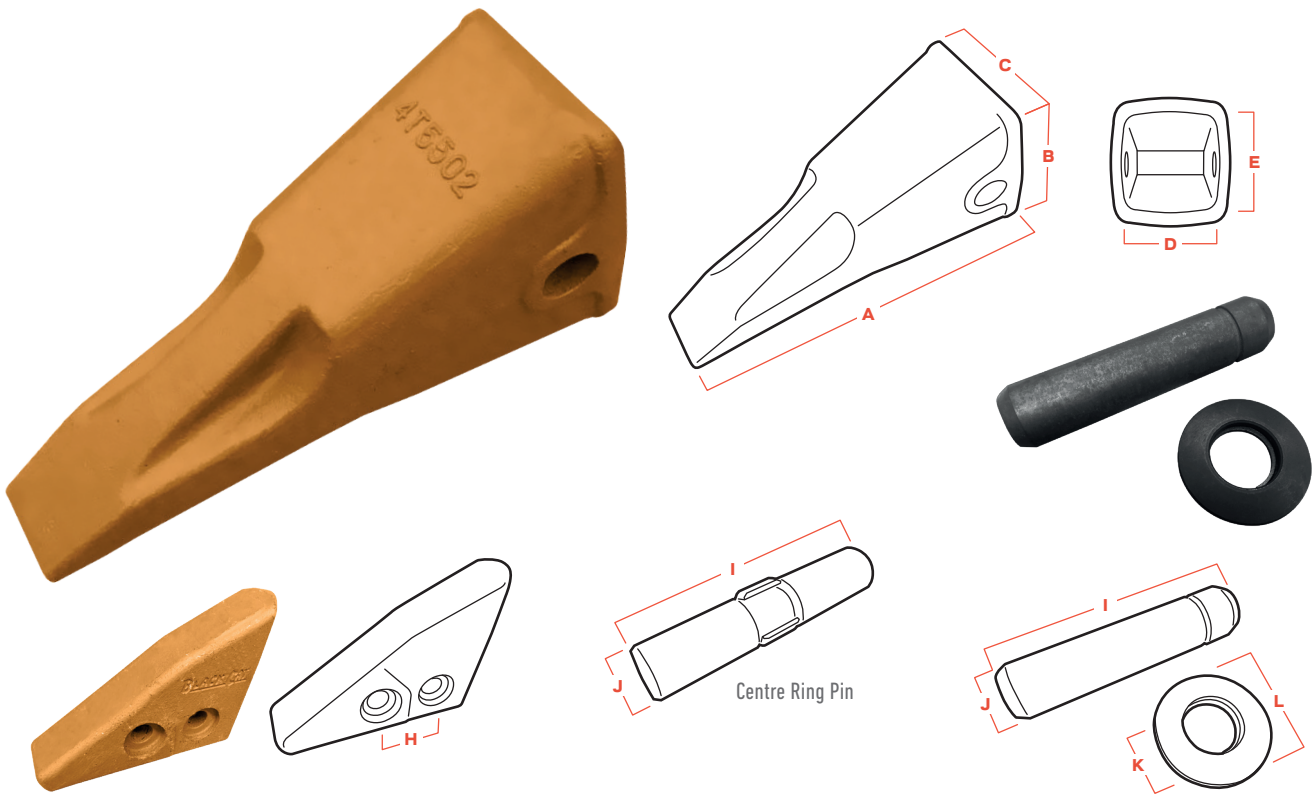

Boots

PRODUCT	PART NUMBER	WEIGHT (KG)	EXTERIOR			POCKET	
			A	B	C	D	E
D10/11 Penetration Intermediate	RC-4T5502	30.4	425	235	165	105	180
D10/11 Penetration Long	RC-4T5503	30.5	470	235	165	105	180

Noses & Protectors

PRODUCT	PART NUMBER	WEIGHT (KG)	F	G	H	I
			LENGTH	INTERNAL GAP	HOLE SPACING	THICKNESS
D10/11 Weld On Nose	RC-1073361	43.5	-	-	115	100

Pins & Retainers

∅ = Diameter

PRODUCT	PART NUMBER	WEIGHT (KG)	PIN		RETAINER	
			I	J	K	L
D10/11 Pin	RC-6Y1204	0.9	142	33	-	-
D10/11 Retainer	RC-6Y1202	12.8	-	-	63	31
D10/11 Pin – Centre Ring	RC-6J8811	0.7	115	32	-	-
D10/11 Long Pin – Centre Ring	RC-3G0500	0.9	152	32	-	-

All measurements in millimetres.



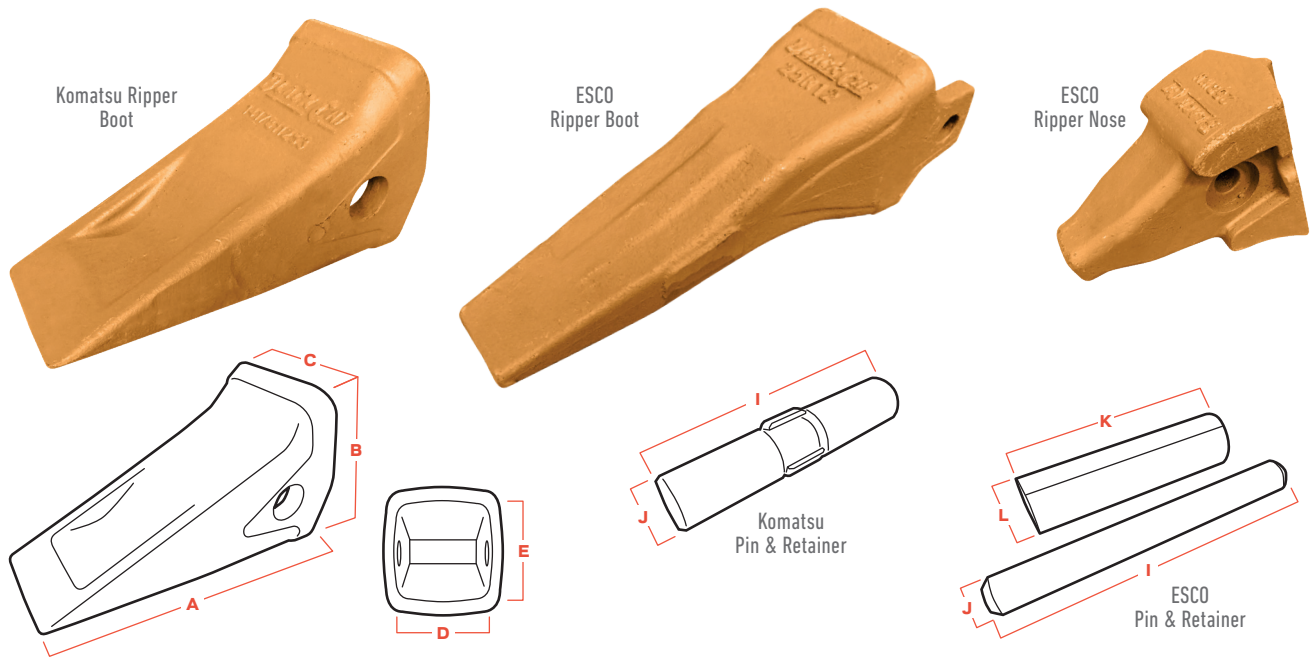

Boots

PRODUCT	PART NUMBER	WEIGHT (KG)	EXTERIOR			POCKET	
			A	B	C	D	E
ESCO 22 Ripper Boot	RE-22R10	3.8	270	92	85	60	75
ESCO 25 Ripper Boot	RE-25R112HX	6.3	306	114	97	66	90
ESCO 35 Ripper Boot	RE-35R15HX	14.6	394	165	125	90	120
ESCO 39 Ripper Boot	RE-39R16	22.8	460	191	155	95	132
Komatsu D60-D75 Ripper Boot	RK-1417811253	11.7	280	163	122	80	110
Komatsu D275/D355 Ripper Boot	RK-1957821331	16.8	360	196	124	80	160

Noses

PRODUCT	PART NUMBER	WEIGHT (KG)	LENGTH	DEPTH	THICKNESS
ESCO 25 Weld On Nose	RE-25WN	8.3	-	-	-
ESCO 35 Weld On Nose	RE-35WN_(35RN)	20.0	-	-	-

Pins & Retainers

∅ = Diameter

PRODUCT	PART NUMBER	WEIGHT (KG)	PIN		RETAINER	
			I	J	K	L
ESCO 22 Ripper Pin / Retainer	RE-22RP / RE-22RB	0.1 / 0.1	LENGTH	DIAMETER	LENGTH	DIAMETER
ESCO 25 Ripper Pin / Retainer	RE-25RPG / RE-25RBG	0.1 / 0.2	83	13	56	21
ESCO 35 Ripper Pin / Retainer	RE-35RP / RE-35RB	0.2 / 0.1	94	13	62	21
ESCO 39 Ripper Pin / Retainer	RE-39RP / RE-39RB	0.2 / 0.1	121	13	81	21
Komatsu Pin for D60-D355 Boot	TK-1757821740P	0.3	133	13	89	21
			117	25	-	-

All measurements in millimetres.